

# Borgaonkar *Elegance*

## THE VASTU COMPLIANT HOMES

Beturkar Pada, Kalyan (W)

STARTING  
FROM

**49.99** Lacs\*



Artistic Impression

### 1 BHK & 2 BHK

Spacious Flats With Parking In Affordable Price

For More Inquiry

+91 80 870 970 00 | +91 96 99 771 999

A PROJECT BY

**Borgaonkar** Group

UPGRADING LIFESTYLE



MAHA RERA. P51700051841



### Plumbing

Concealed plumbing work with Branded CP fittings good quality sanitary fittings



### Painting

Plastic paint in entire flat and acrylic paint for external walls.



### Kitchen

Granite kitchen platform, service platform, SS sink and designer tiles.



### Electrical

Concealed copper wiring with ISI mark MCB Switches



### Structure

Well designed RCC structure Earthquake resistant design with Attractive Elevation.



### Flooring

Vitrified flooring tiles in entire flats.



### Doors & Windows

Main door RM frame with decorative flush door. All internal doors RM frames With flush door.

# AMENITIES

**Hitech Lift**

**CCTV camera**

**24/7 Security**

**Car parking**

**Roof Top Amenities**

**Power Battery Backup**

**Entrance Lobby With Pop Decorative Ceiling**

# FLOOR PLAN 1st To 5th

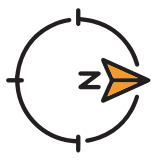
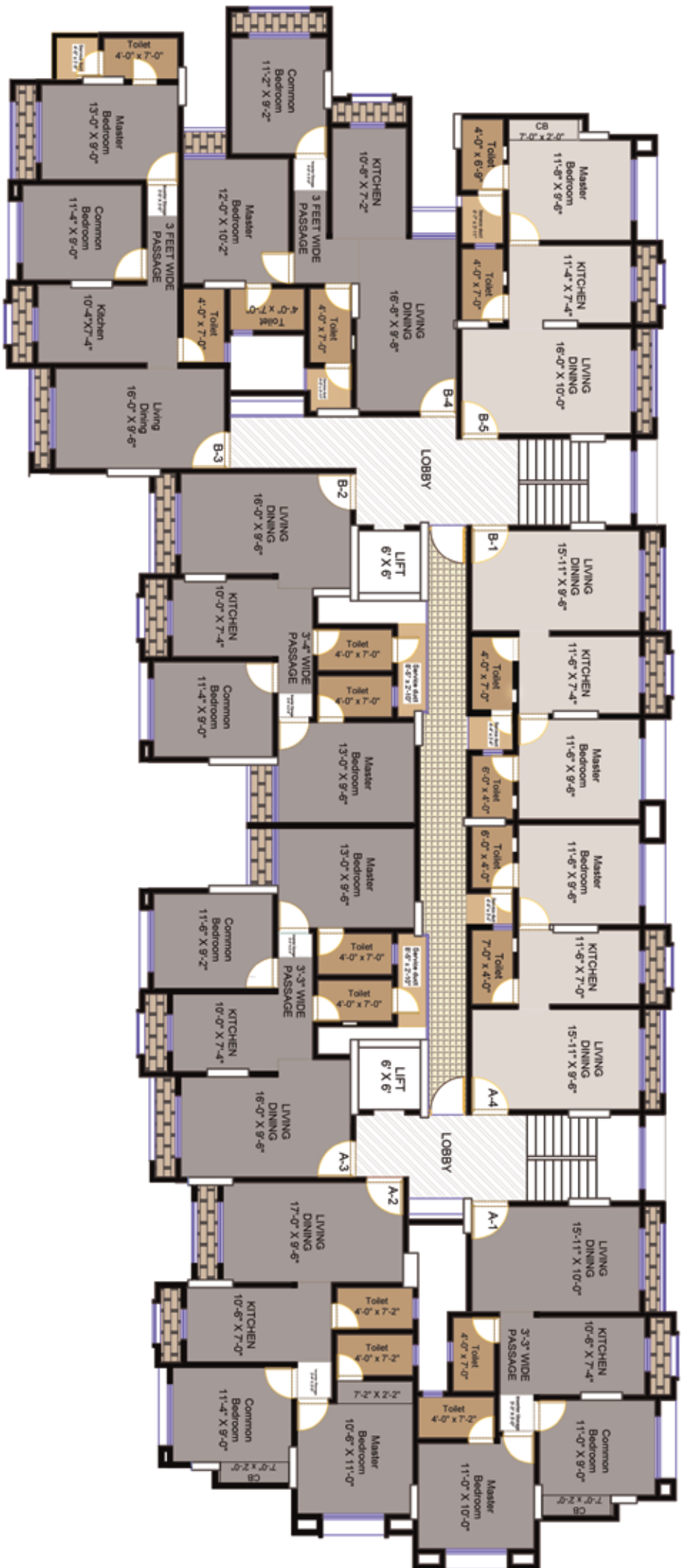



# ONGOING AND COMPLETED PROJECTS

- ▶ Borgaonkar Avenue
- ▶ HUB'S Residency
- ▶ Sahara Buildcon
- ▶ Rock Mount Residency
- ▶ Tulsi Park
- ▶ Heena Ashish



MAHA RERA. P51700051841

Site Address - Opposite Panchamukhi Maruti Mandir

Beturkar Pada, Khadakpada ,Kalyan (w)

Corporate Office - E4 & E5 , 2<sup>nd</sup> Floor CHARMS STAR Building,

Bail Bazar Chowk, Near Sanai Marriage Hall, Kalyan (w).

